

## REPLACEMENT

### 1. REMOVE FRONT WHEEL

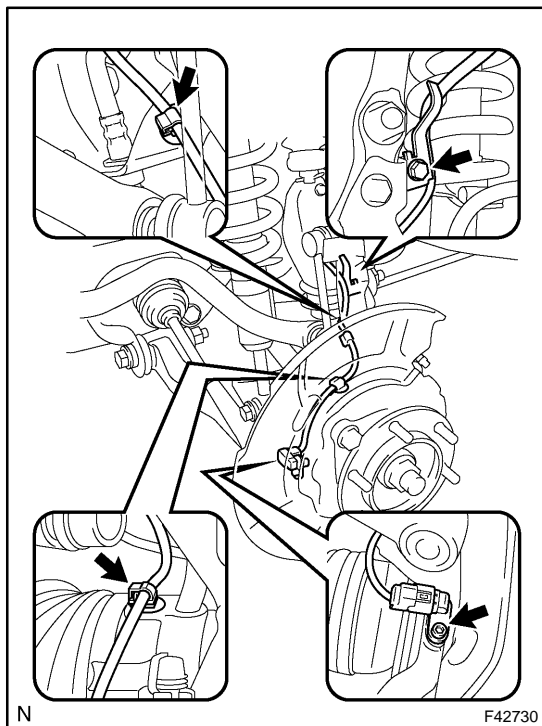

### 2. SEPARATE SPEED SENSOR FRONT LH

- Using a hexagon wrench, separate the speed sensor front LH.
- Disconnect the 2 clamp.
- Remove the bolt and separate the speed sensor wire harness from the steering knuckle.

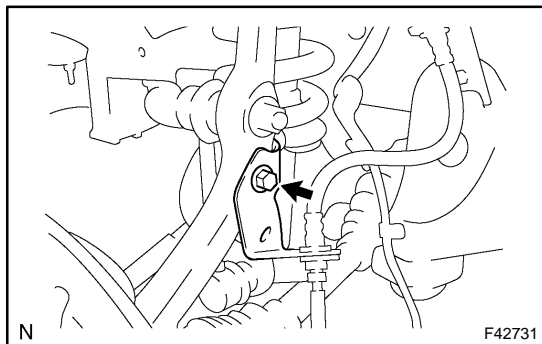

### 3. REMOVE FRONT DISC BRAKE CALIPER ASSY LH

- Remove the bolt and separate the brake tube bracket from the steering knuckle.
- Using SST, disconnect the brake tube from the front disc brake caliper assy LH.  
SST 09023-00100

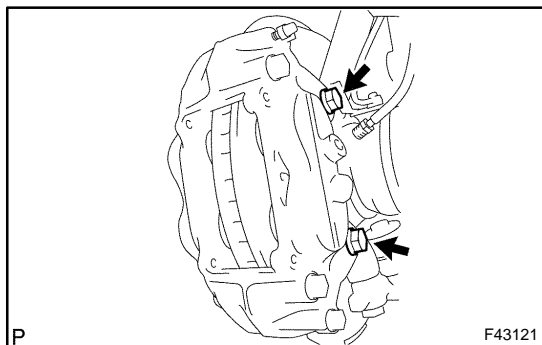

- Remove the 2 bolts and front disc brake caliper assy LH.

### 4. REMOVE FRONT DISC

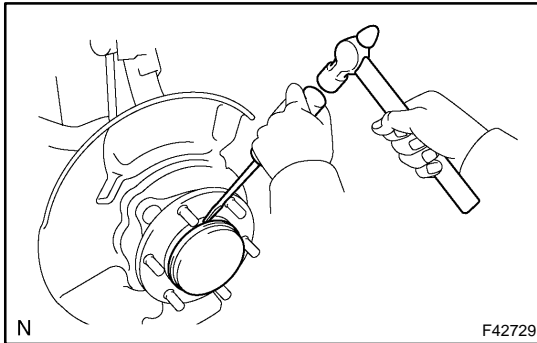

#### 5. REMOVE FRONT AXLE HUB GREASE CAP LH (4WD DRIVE TYPE)

- (a) Using a screwdriver and a hammer, remove the front axle hub grease cap LH.

#### NOTICE:

Do not damage the axle hub.

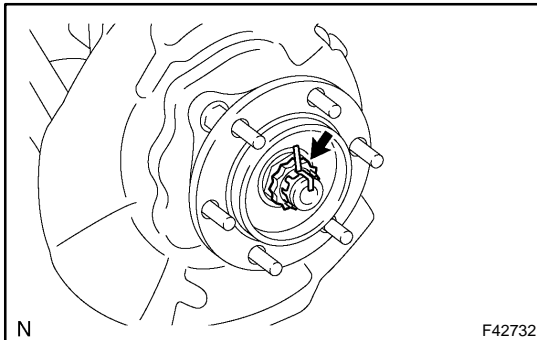

#### 6. REMOVE FRONT AXLE HUB LH NUT (4WD DRIVE TYPE)

- (a) Remove the cotter pin and a lock cap.  
(b) Remove the front axle hub LH nut.

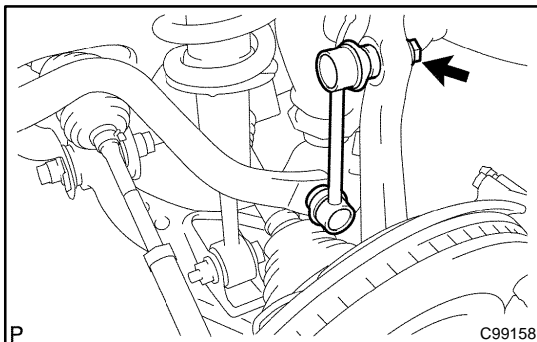

#### 7. SEPARATE FRONT STABILIZER LINK ASSY LH

- (a) Remove the nut and separate the stabilizer link assy LH from the steering knuckle.

#### HINT:

If the ball joint turns together with the nut, use a hexagon (6 mm) wrench to hold the stud.

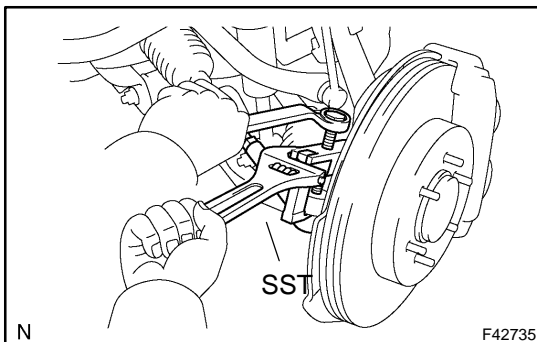

#### 8. SEPARATE TIE ROD END SUB-ASSY LH

- (a) Remove the cotter pin and nut.  
(b) Using SST, separate the tie rod end sub-assy LH from the steering knuckle.

SST 09628-6201 1

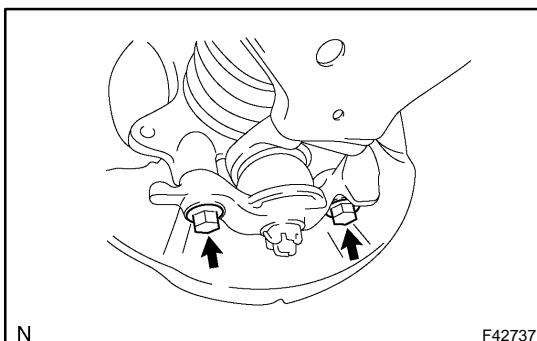

#### 9. SEPARATE FRONT SUSPENSION ARM SUB-ASSY LOWER NO.1 LH

- (a) Remove the 2 bolts and separate the front suspension arm sub-assy lower No.1 LH from the steering knuckle.

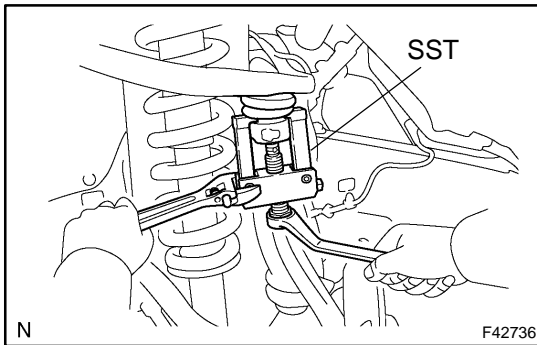

#### 10. SEPARATE FRONT SUSPENSION UPPER ARM ASSY LH

- (a) Remove the cotter pin and nut.
- (b) Using SST, separate the steering knuckle from the front suspension upper arm assy LH.

SST 09628-6201 1

#### 11. REMOVE FRONT AXLE HUB ASSEMBLY

- (a) 4WD Drive Type:  
Using a plastic hammer, separate the front axle hub from the front drive shaft.
- (b) Remove the front axle hub sub-assy LH.

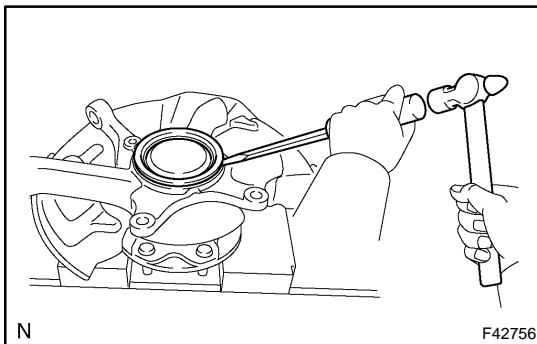

#### 12. REMOVE KNUCKLE GREASE RETAINER CAP INNER (2WD DRIVE TYPE)

- (a) Using a screwdriver and hammer, remove the knuckle grease retainer cap inner.

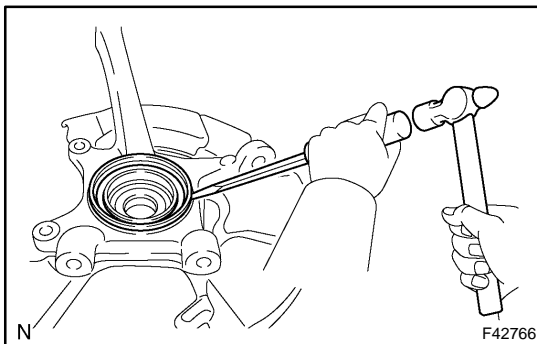

#### 13. REMOVE STEERING KNUCKLE LH OIL SEAL (4WD DRIVE TYPE)

- (a) Using a screwdriver and hammer, remove the steering knuckle LH oil seal.

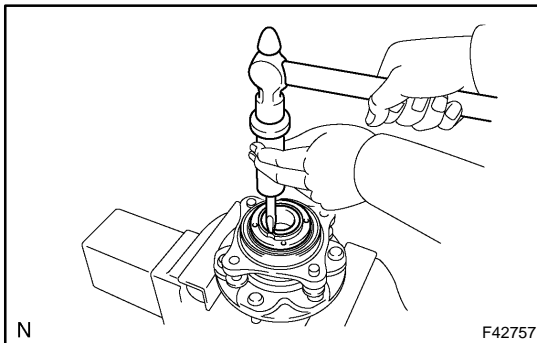

#### 14. REMOVE FRONT WHEEL ADJUSTING NUT LH (2WD DRIVE TYPE)

- (a) Using SST and a hammer, unstage the adjusting nut.

SST 09930-00010

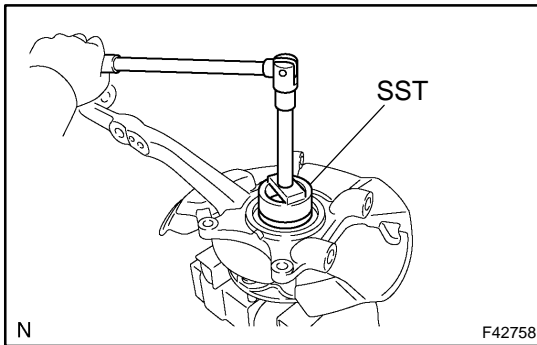

- (b) Using SST, remove the adjusting nut.  
SST 09318-12010

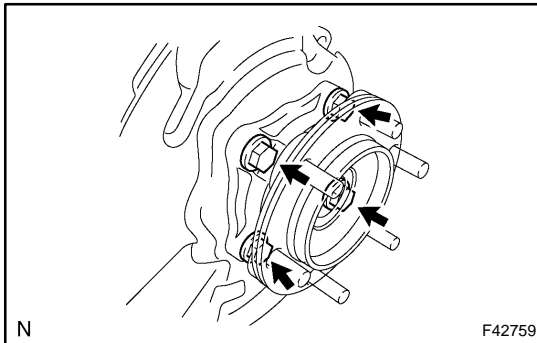

### 15. REMOVE FRONT AXLE HUB

- (a) Remove the 4 bolts and axle hub from the steering knuckle.  
(b) Remove the O-ring from the axle hub.

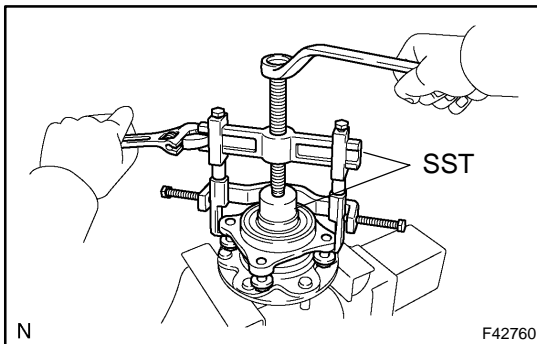

### 16. REMOVE FRONT AXLE W/ABS ROTOR LH BEARING ASSY

- (a) Fix the front axle hub soft in vise.  
(b) Using SST, remove the bearing.  
SST 09710-30021 (09710-03051), 09950-40011  
(09951-04020, 09952-04010, 09953-04020,  
09954-04010, 09955-04061, 09957-04010,  
09958-0401 1)

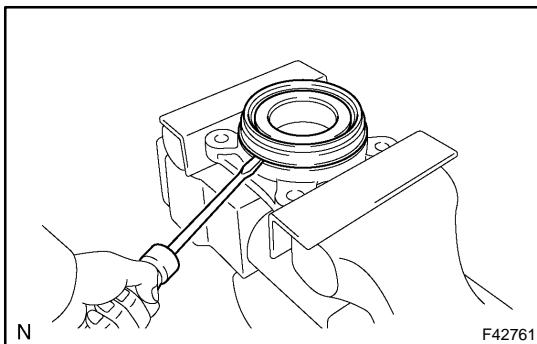

### 17. REMOVE FRONT AXLE HUB LH SPACER

- (a) Using a screwdriver, remove the front axle hub LH spacer.

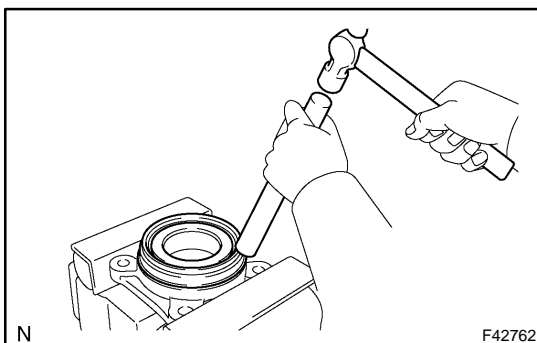

### 18. INSTALL FRONT AXLE HUB LH SPACER

- (a) Using a brass bar and a hammer, install the new front axle hub LH spacer.

#### NOTICE:

**Do not damage the spacer.**

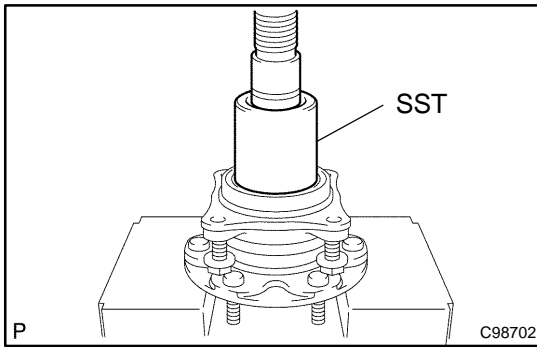

### 19. INSTALL FRONT AXLE W/ABS ROTOR LH BEARING ASSY

- (a) Using SST and a press, install the new bearing to the front axle hub.

SST 09649-17010

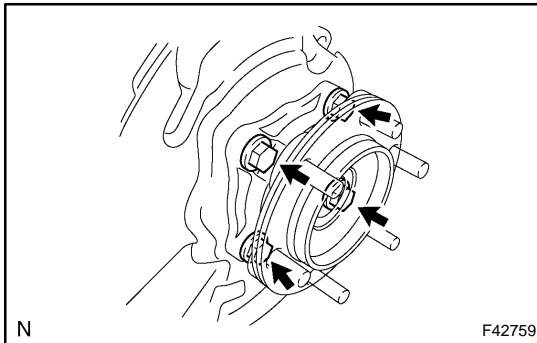

### 20. INSTALL FRONT AXLE HUB

- (a) Apply the MP grease to a new O-ring.  
 (b) Install the new O-ring to the axle hub.  
 (c) Install the dust cover, axle hub to the steering knuckle with the 4 bolts.

**Torque: 80 N·m (816 kgf·cm, 59 ft·lbf)**

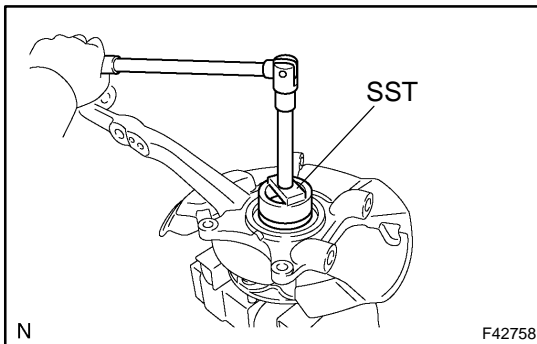

### 21. INSTALL FRONT WHEEL ADJUSTING NUT LH (2WD DRIVE TYPE)

- (a) Using SST, install a new adjusting nut.

**Torque: 275 N·m (2,804 kgf·cm, 203 ft·lbf)**

SST 09318-12010

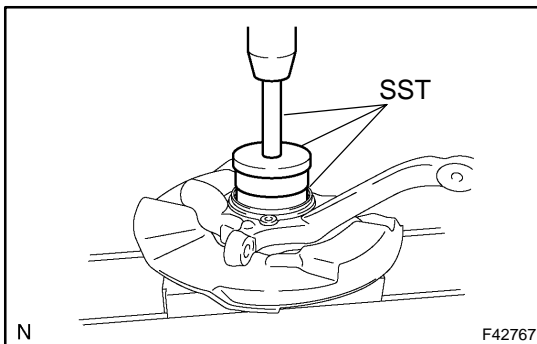

### 22. INSTALL STEERING KNUCKLE LH OIL SEAL (4WD DRIVE TYPE)

- (a) Using SST and a press, install a new steering knuckle LH oil seal.

SST 09527-17011, 09950-70010 (09951-07100), 09951-01000

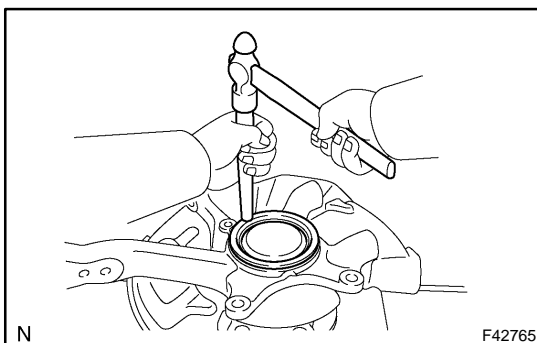

### 23. INSTALL KNUCKLE GREASE RETAINER CAP INNER (2WD DRIVE TYPE)

- (a) Using a brass bar and a hammer, install a new knuckle grease retainer cap inner.

#### NOTICE:

**Do not damage the knuckle grease retainer cap inner.**

## 24. INSTALL FRONT AXLE HUB ASSEMBLY

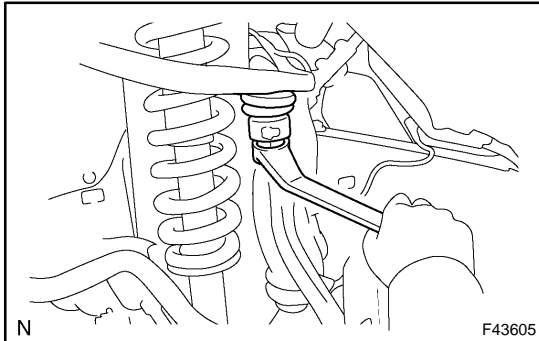

### 25. INSTALL FRONT SUSPENSION UPPER ARM ASSY LH

- (a) Install the front suspension upper arm assy LH with a nut.  
**Torque: 110 N·m (1,122 kgf·cm, 81 ft·lbf)**
- (b) Install a new cotter pin.

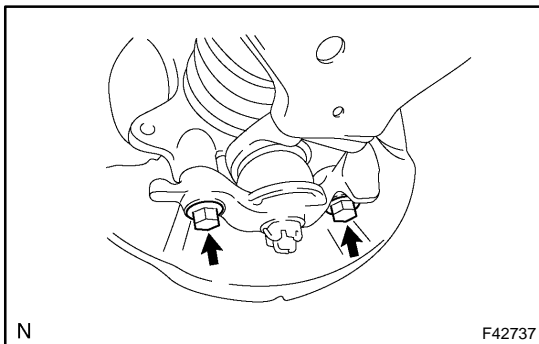

### 26. INSTALL FRONT SUSPENSION ARM SUB- ASSY LOWER NO.1 LH

- (a) Install the front suspension arm sub-assy lower No.1 LH with the 2 bolts.  
**Torque: 225 N·m (2,294 kgf·cm, 166 ft·lbf)**

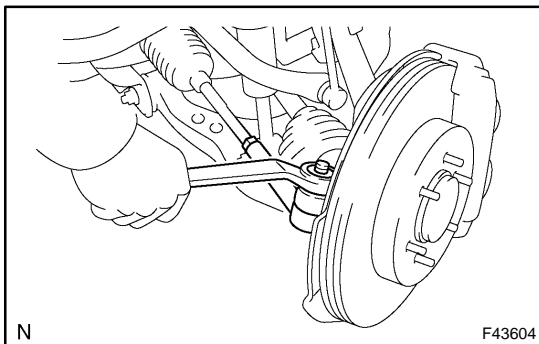

### 27. INSTALL TIE ROD END SUB-ASSY LH

- (a) Install the tie rod end sub-assy LH with a nut.  
**Torque: 91 N·m (928 kgf·cm, 67 ft·lbf)**
- (b) Install a new cotter pin.

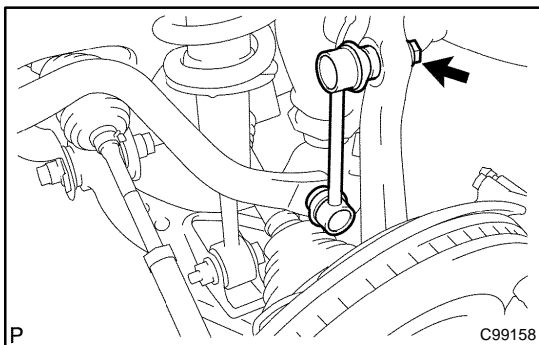

### 28. INSTALL FRONT STABILIZER LINK ASSY LH

- (a) Install the stabilizer link with a nut to the steering knuckle.  
**Torque: 70 N·m (714 kgf·cm, 52 ft·lbf)**

#### HINT:

If the ball joint turns together with the nut, use a hexagon (6 mm) wrench to hold the stud.

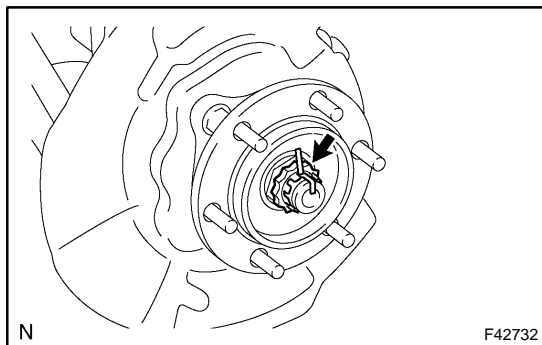

## 29. INSTALL FRONT AXLE HUB LH NUT (4WD DRIVE TYPE)

- (a) Install the hub nut.  
**Torque: 235 N·m (2,396 kgf·cm, 173 ft·lbf)**
- (b) Install the adjusting cap and cotter pin.

## 30. INSTALL FRONT AXLE HUB GREASE CAP LH (4WD DRIVE TYPE)

## 31. INSTALL FRONT DISC

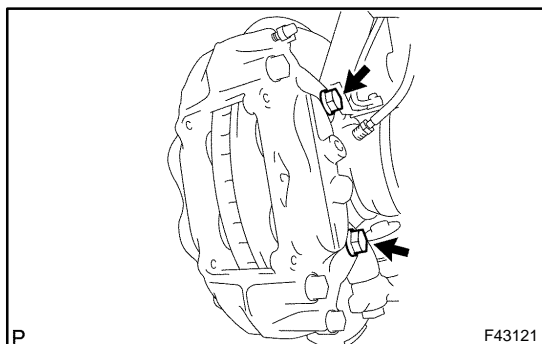

## 32. INSTALL FRONT DISC BRAKE CALIPER ASSY LH

- (a) Install the front disc brake caliper assy LH with the 2 bolts.  
**Torque: 123 N·m (1,254 kgf·cm, 91 ft·lbf)**

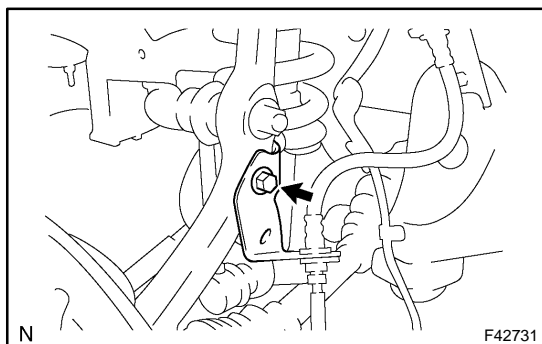

- (b) Install the brake tube bracket to the steering knuckle with a bolt.

**Torque: 29 N·m (296 kgf·cm, 21 ft·lbf)**

- (c) Using SST, connect the brake tube to the disc brake caliper assy.

SST 09023-00100

**Torque: 15 N·m (155 kgf·cm, 11 ft·lbf)**

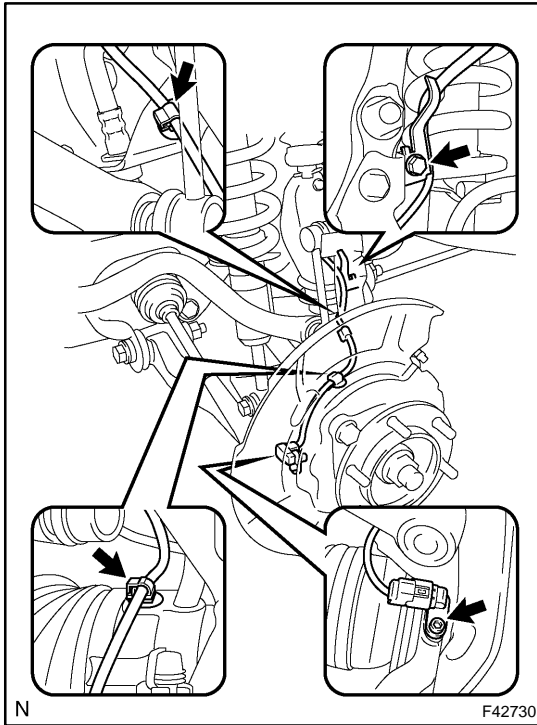
**33. INSTALL SPEED SENSOR FRONT LH**

- (a) Install the speed sensor wireharness to the steering knuckle with a bolt.

**Torque: 13 N·m (133 kgf·cm, 10 ft·lbf)**

- (b) Connect the 2 clips.

- (c) Using a hexagon wrench, install the speed sensor with the bolt.

**Torque: 8.3 N·m (85 kgf·cm, 73 in·lbf)**

**34. BLEED BRAKE LINE (See page 32-4 )**

**35. CHECK FLUID LEVEL IN RESERVOIR (See page 32-4 )**

**36. CHECK BRAKE FLUID LEAKAGE (See page 32-4 )**

**37. INSTALL FRONT WHEEL**

**Torque: 112 N·m (1,142 kgf·cm, 83 ft·lbf)**

**38. INSPECT AND ADJUST FRONT WHEEL ALIGNMENT (See page 26-7 )**

**39. CHECK ABS SPEED SENSOR SIGNAL (See page 05-307 )**